

OWNER'S MANUAL

HYDRAULIC ADAPTER KIT

for
NT3M9 (Type D & Later)
&TR1



APPLICATION

Used to couple hydraulic motor (SAE J744C Mounting flange) with NT3M9 pump.

INSTALLATION

- 1) Remove existing end cover.
- 2) Cut shaft to dim. shown.
- 3) Assemble coupling (item 2) to shaft and lock in place with key (item 3) and set screw (item 5).
- 4) Position adapter (item 1) and tighten 4 bolts (item 6) with washers (item 7).
- 5) Mount hydraulic motor.

*For pumps supplied open bearings. Install grease fitting and grease bearings.

HYDRAULIC MOTOR REQUIREMENTS

The hydraulic motor must have an SAE Standard (SAE J744C) mounting flange and shaft size B, with 30° involute spline, 13T, 16/32 pitch, as shown in Fig. 2.

The hydraulic motor must produce the torque required to drive the centrifugal pump at the desired operating speed. For the centrifugal pump GPM and TDH, read the required RPM and BHP from the pump performance curve calculate the required torque, in Lbs, as follows:

$$\text{Torque} = \frac{(5252) \times (\text{BHP})}{(\text{RPM})}$$

The hydraulic motor selected must match with the flow and pressure capability of the hydraulic power source system. The operating speed of the centrifugal pump will be controlled by valves in the hydraulic power source system.

Operate pump to maximum speed of 2600 RPM.

PUMP SPEEDS

Maximum speed for NT3M9 is 2600 RPM for TR1 maximum speed refer to TR1 selection in EP manual.

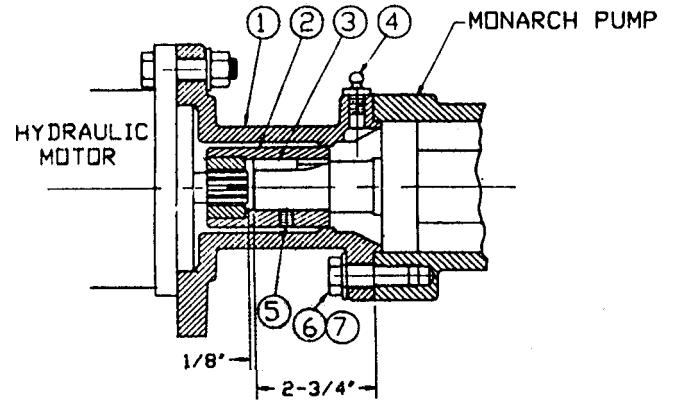

FIG.1

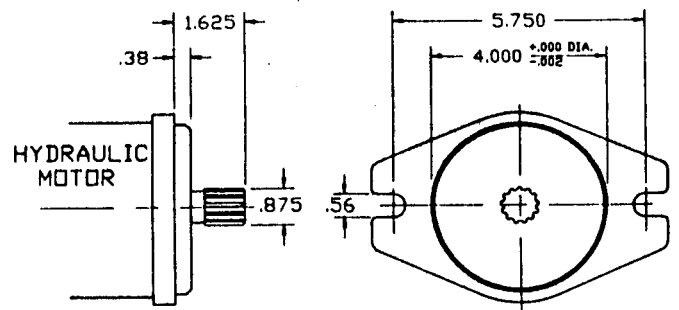

FIG. 2